

**PB550DR DZR full bore quarter turn ball valve**

blue lever, handle female ends, PN25



**Sizes**

**Taper**

Range	½"	¾"	1"	1 ¼"	1 ½"	2"
ISO7-1 Rc (Taper)	245201	245202	245203	245204	245205	245206
ISO 228 (PT)	245150	245151	245152	242153	245154	245155

**Dimensions (mm)**

Range	½"	¾"	1"	1 ¼"	1 ½"	2"
A	59.0	68.0	80.0	95.0	100.0	124.0
B	39.0	51.0	56.0	63.0	78.0	88.0
Weight kg	0.23	0.41	0.61	0.94	1.33	2.21

**Flow rates\***

Range	½"	¾"	1"	1 ¼"	1 ½"	2"
Cv	19.9	48.0	81.9	141.6	234.0	341.6
Kv	17.0	41.0	70.0	121.0	200.0	292.0

\*Cv - flow rate in US GPM at a pressure drop of 1 psi.

\*Kv - flow rate in m3 per hour at a pressure drop of 1 bar.

**Valve suitability**

Steam	Water	Oil	Air	Gas inert	Gas combustible	Gas corrosive	Gas oxygen
✓	✓	✓	✓	✗	✗	✗	✗

Air maximum - 10 bar

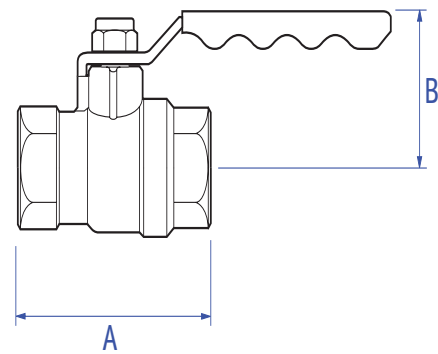

**Material specification**

Component	Material
Body	DZR Brass
Body cap	DZR Brass
Ball	Brass, chrome plated
Stem	DZR Brass
Stem 'O' ring	Viton
Seat rings	PTFE (Teflon)
Lever handle	Steel
Lever nut (self locking)	Zinc plated steel

**Maximum pressure conditions**

Size	Maximum working pressure (bar)		Test pressures (bar)	
	Temp up to 100°C	Temp up to 150°C	Shell	Seat
½" to 2"	25.0	16.5	37.5	27.5

Size	Maximum working pressure (psi)		Test pressures (psi)	
	Temp up to 362.6°F	Temp up to 302°F	Shell	Seat
½" to 2"	293.3	239.0	543.9	398.9

Temperature range - 10°C + 150°C (non shock)

**Pressure equipment directive category**

Size	½"	¾"	1"	1 ¼"	1 ½"	2"
	SEP	SEP	SEP	SEP	SEP	SEP

**Pressure & temperature ratings**

